

NOTE:
 FOR THE MOST CURRENT STATION DESIGN FOR CENTER-PLATFORMS AT-GRADE, SPLIT-PLATFORMS AT-GRADE, AND CENTER-PLATFORMS ABOVE-GRADE (AERIAL), REFER TO FLOWER & 23RD., FLOWER & JEFFERSON AND LA BREA RESPECTIVELY. THESE STATIONS REPRESENT A LEVEL OF DESIGN THAT THE CONTRACTOR SHALL ACHIEVE FOR ALL STATIONS. THE ELEMENTS INCLUDING, BUT NOT LIMITED TO, CANOPY DESIGN, PLATFORM DESIGN, DIMENSIONS AND OTHER DESCRIPTIONS, SHALL BE APPLIED TO ALL STATIONS.

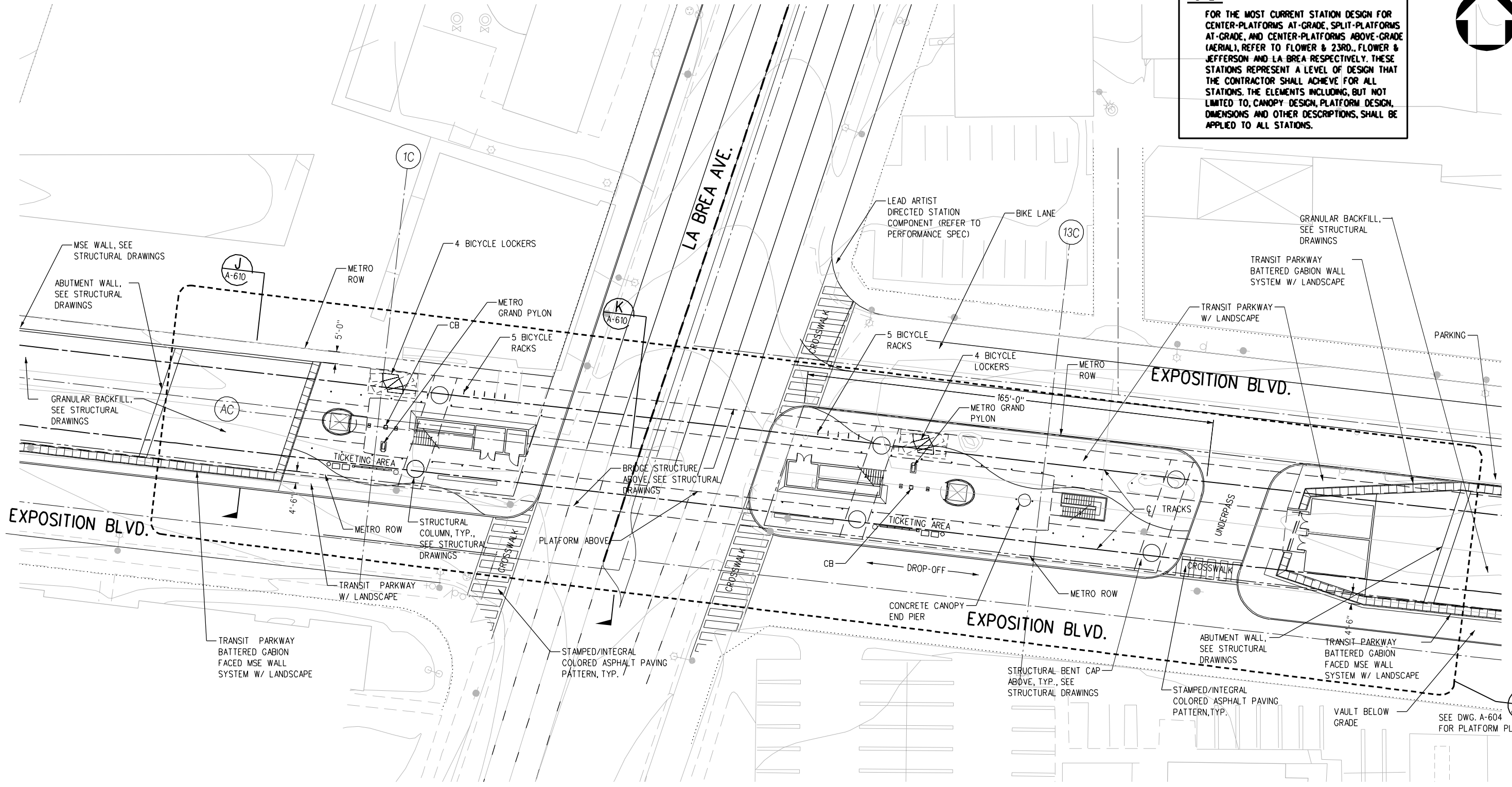

SITE PLAN
 1" = 20'-0"

1 A-602



PRELIMINARY - NOT FOR CONSTRUCTION

REV	DATE	BY	APP	REG NO	EXPIRES	SEAL HOLDER	DESCRIPTION
0	7/28/05	-	-	-	-		ISSUED FOR DESIGN BUILD RFP

DESIGNED BY
C. STEVENS
 DRAWN BY
J. KOUZOUYAN
 CHECKED BY
L. PADILLA
 IN CHARGE
R. STEWART
 DATE
11/26/03



LOS ANGELES COUNTY METROPOLITAN TRANSPORTATION AUTHORITY

DMJM HARRIS | AECOM
 707 WILSHIRE BLVD., SUITE #3300
 LOS ANGELES, CALIFORNIA 90017
 TEL (213) 922-9200
 FAX (213) 922-9559

SUBMITTED _____
 APPROVED _____

MID-CITY/EXPOSITION LRT CORRIDOR

LA BREA STATION SITE PLAN

CONTRACT NO
E0016
 DRAWING NO
A-602
 SCALE
1" = 20'-0"
 SHEET NO